

RECEIVED  
LARAMIE COUNTY  
CHEYENNE, WY.

CERTIFIED LAND CORNER RECORDATION <sup>188</sup>MAY 18 PM 4 19

DESCRIPTION OF CORNER EVIDENCE FOUND, AND ORIGINAL RECORD (If known)

Township 14N.  
R. 63W.  R. 64W.

Laramie County, Wyoming. Found Railroad spike 0.2 feet below surface and 1.1 feet west of centerline of County Road 142.

DESCRIPTION OF MONUMENT AND ACCESSORIES ESTABLISHED TO PERPETUATE THE ORIGINAL LOCATION OF THIS CORNER:

SKETCH, WITH COURSE AND DISTANCE TO ADJACENT CORNER IF DETERMINED IN THIS SURVEY. (May Sketch or Paste Reproduction on Reverse Side.)

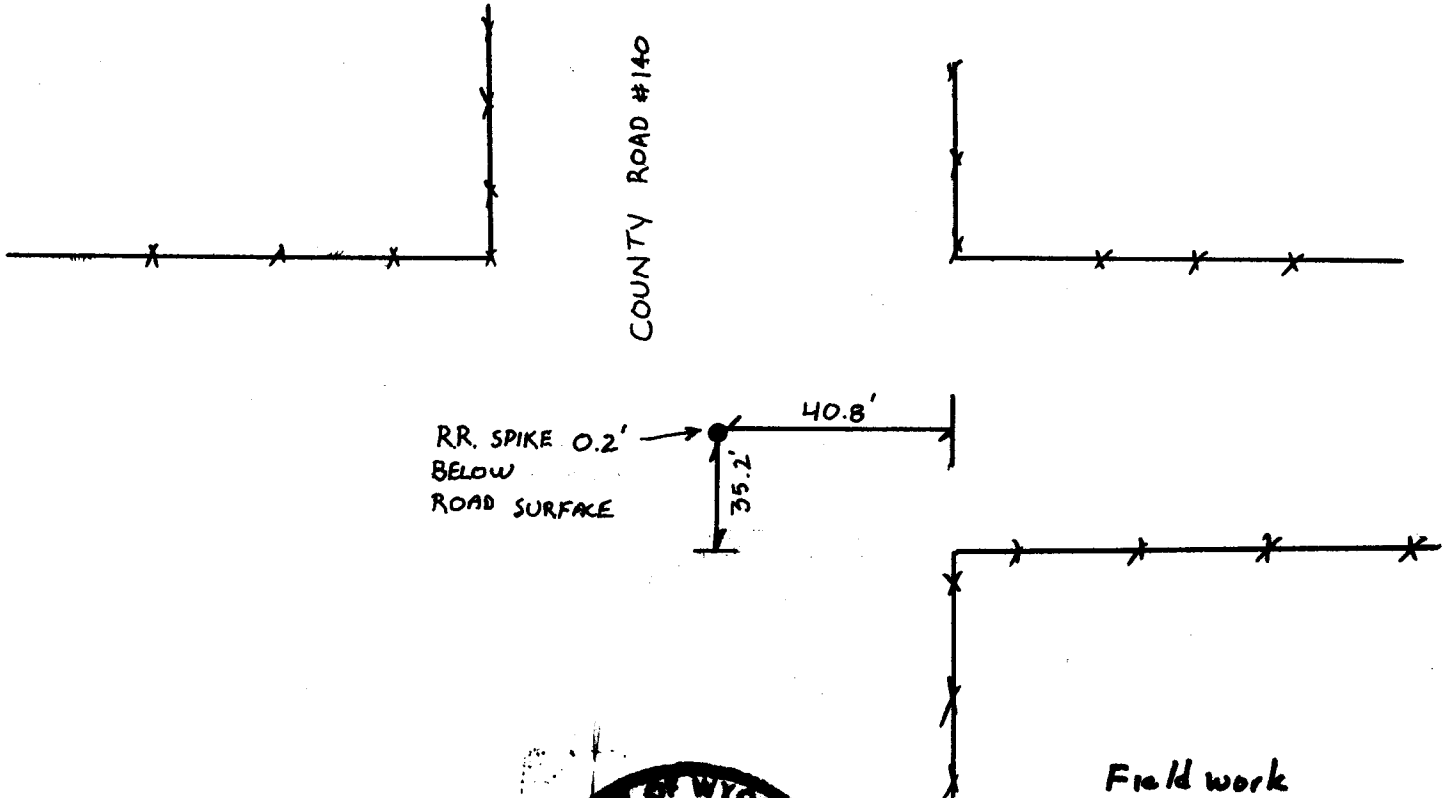

Field work  
5/4/28

I, Becky J. Braman certify that I have carefully performed or reviewed the work done on the diagrammed corner as reported on this registration form and approve the same.

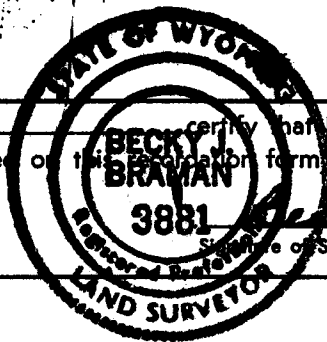

Becky J. Braman PLS 3881  
Registration No.

STATE OF WYOMING,  
Office of Clerk and Recorder,  
County of \_\_\_\_\_

This "corner record" was filed for record on the 18<sup>th</sup> day of May, 1928, was noted on the cross-index plat and is assigned page No. \_\_\_\_\_, in book No. \_\_\_\_\_

Frank C. Whitcomb  
County Official

Cross Index No. <u>E 1</u>	T. <u>14 N</u>	R. <u>63 W</u>	Mer.
<u>E 25</u>	T. <u>14 N</u>	R. <u>64 W</u>	Mer.
_____	T. _____	R. _____	Mer.
_____	T. _____	R. _____	Mer.
_____	T. _____	R. _____	Mer.
_____	T. _____	R. _____	Mer.
_____	T. _____	R. _____	Mer.